



Chelmer Road, London, E9

BUTLER & STAG



Substantial four bedroom end of terrace townhouse situated in close proximity to the ever changing Chatsworth Road and the bustling Lower Clapton Road. Both high streets offer an abundance of amenities in addition to bus routes Leading directly in to London. The property boasts a 26ft+ living room with doors leading to a court yard garden, separate modern fully fitted kitchen and ground floor cloakroom.



- Spacious Living Accomodation
- Modern Interiors
- Close to Overground (Homerton)
- Three Bathrooms
- Close to Amenities
- End Of Terrace





Chelmer Road, E9 6AY

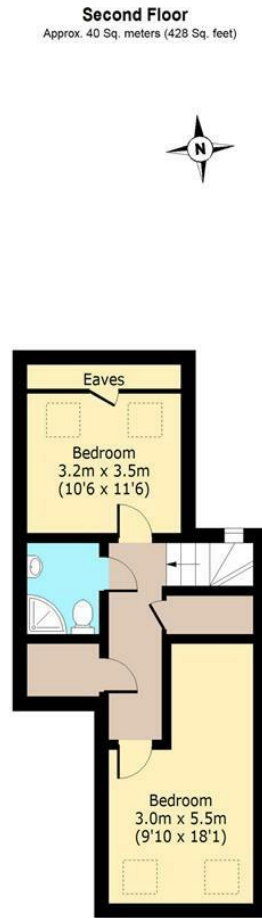
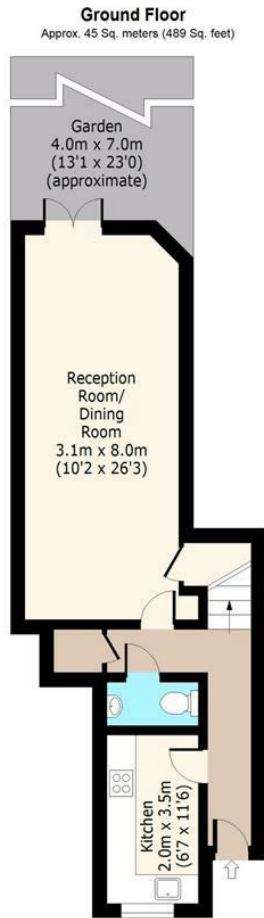

Total area(Including Eaves): approx. 127 Sq. meters (1366 Sq. feet)
Total area(Excluding Eaves): approx. 125 Sq. meters (1346 Sq. feet)
For illustration purposes only - not to scale
www.lpa.plus.com

BUTLER & STAG

☎ 020 8102 1236

🏠 508 Roman Road, Bow, London, E3 5LU

✉ bow@butlerandstag.com

www.butlerandstag.uk

IMPORTANT NOTICE - These particulars have been prepared in good faith and they are not intended to constitute part of an offer or contract. We have not performed a structural survey on this property and the services, appliances and specific fittings have not been tested. All photographs, measurements, floor plans and distances referred to are given as a guide and should not be relied upon.